

CUSTOM FLAG SET

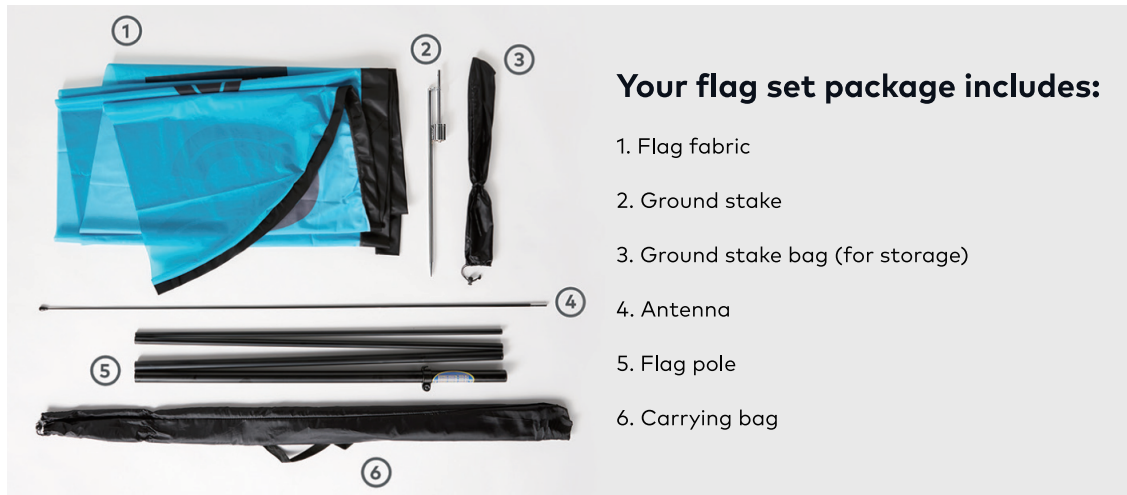

Your flag set package includes:

1. Flag fabric
2. Ground stake
3. Ground stake bag (for storage)
4. Antenna
5. Flag pole
6. Carrying bag

ASSEMBLY GUIDE

Follow these steps to make your flag setup quick and easy. Make sure you have all the pieces listed above and the base you want to use nearby.



1. ASSEMBLE POLES

Attach the segments of your flag pole, and then insert the antenna to the top of the pole set.



2. ADD FLAG MATERIAL

Feed the tip of the antenna through the pocket that runs along the side of your flag.



3. ATTACH BASE

Setup and secure your base. Insert the assembled pole set on the top of your base.

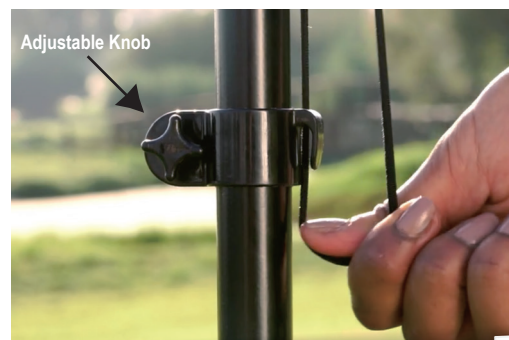

4. SECURE FLAG

Attach the bungee at the bottom of the flag to the adjustable hook on the flag pole. Using the knob opposite the hook to loosen or tighten, adjust the hook up or down as needed for optimal tension. That's it!

Tips & Tricks:

- It is normal for the pole to spin or move around on the base/s. This helps prevent damage to the flag and/or pole in windy conditions.
- The knob/hook combo used to secure the flag to the pole is designed to move up and down to increase or decrease tension. When you have the desired tension please tighten the knob to secure in place.